

# Example Plans: Deck Addition to a Single Family Dwelling Unit

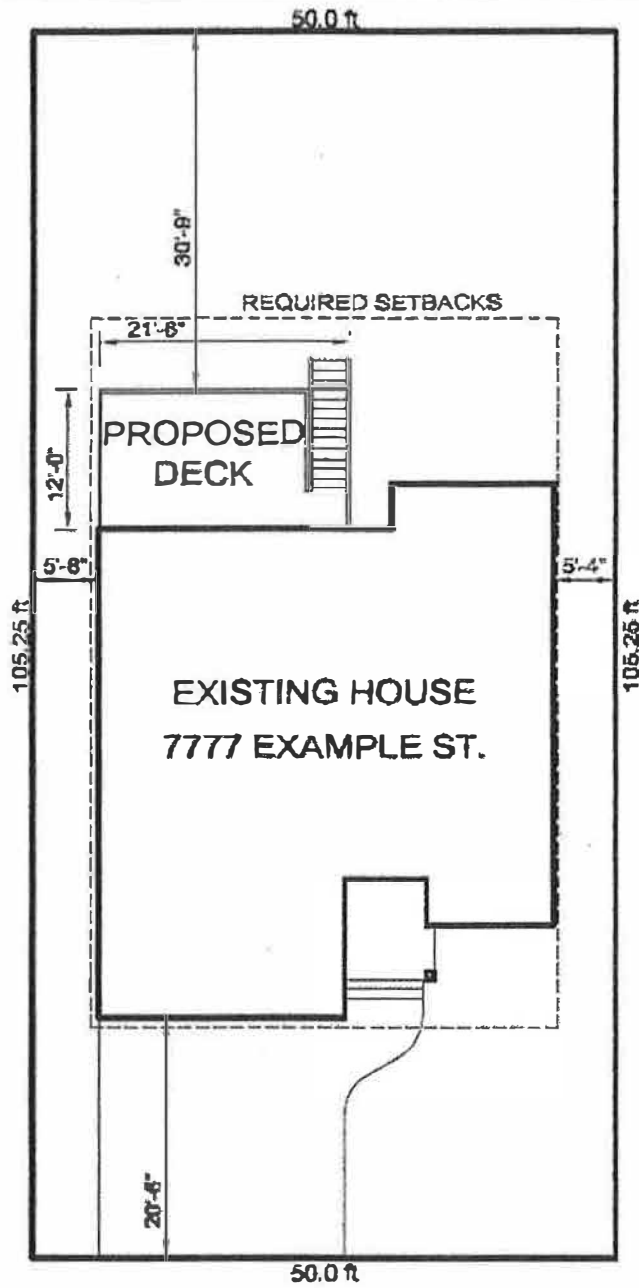

## SITE PLAN

SCALE:  $\frac{1}{16}'' = 1'-0''$

\*\*Note: Actual plans must be drawn on minimum 11x17" size paper. Plans must NOT be drawn on graph or lined paper.

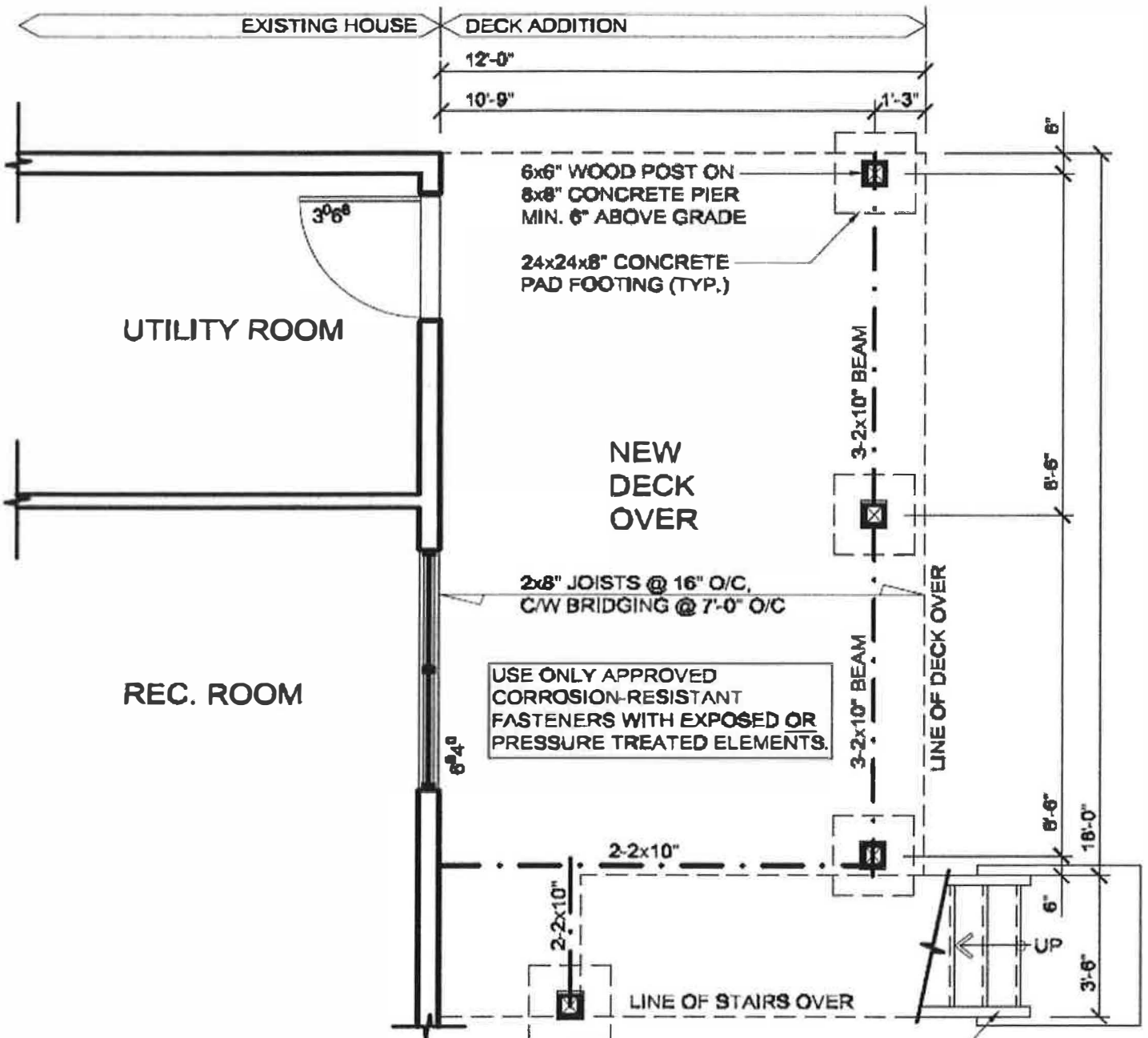

# FOUNDATION PLAN

SCALE:  $\frac{1}{4}" = 1'-0"$

ALL STRUCTURAL WOOD ELEMENTS WITHIN 18" OF GRADE SHALL BE PRESSURE-TREATED TO RESIST TERMITES 9.3.2.9(2)

\*\*Note: Actual plans must be drawn on minimum 11x17" size paper. Plans must NOT be drawn on graph or lined paper.

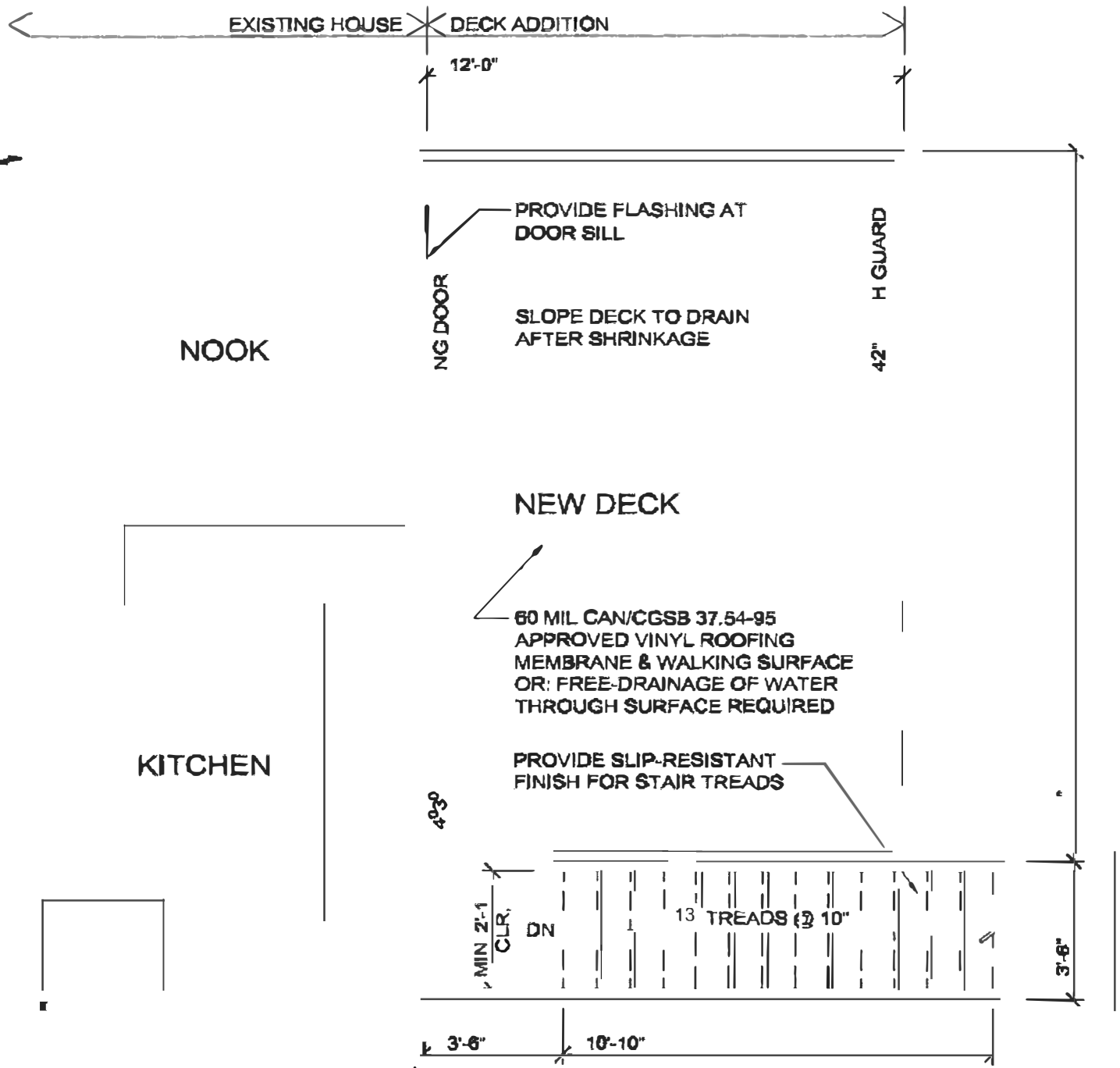

# FLOOR PLAN

SCALE: 1/4" = 1'-0"

\*\*Note: Actual plans must be drawn on minimum 11x17" size paper. Plans must NOT be drawn on graph or lined paper.

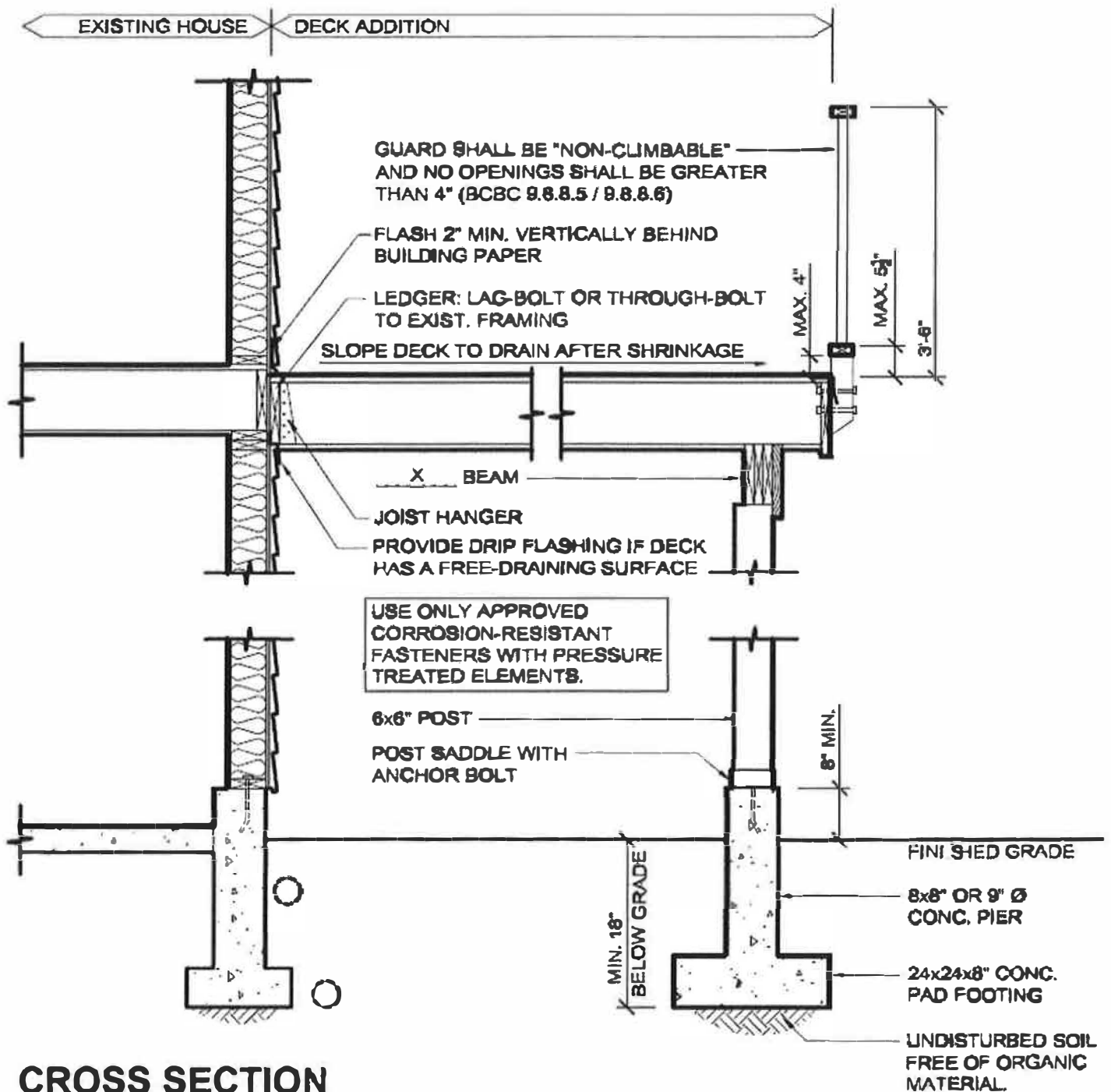

## CROSS SECTION

SCALE:  $\frac{1}{2}$ " = 1'-0"

\*\*Note: Actual plans must be drawn on minimum 11x17" size paper. Plans must NOT be drawn on graph or lined paper.